

**INSTRUCTIONS FOR USE AND INSTALLATION
HOT CUPBOARDS
HVC 60 GN / HVC 120 GN**

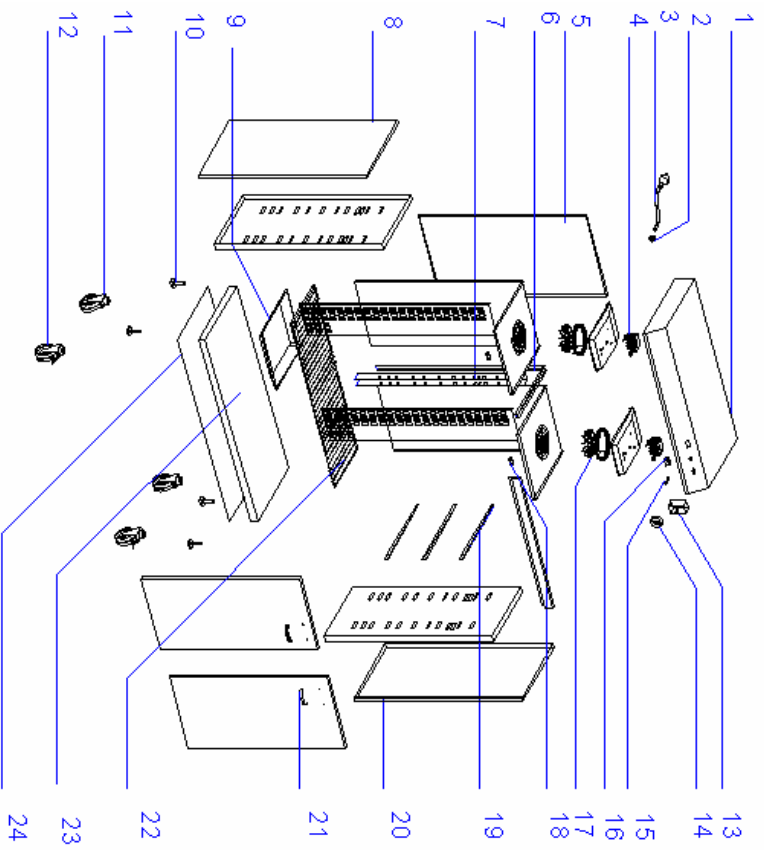

Made in France



HOT CUPBOARDS

HVC 60 GN / HVC 120 GN

Nomenclature **HVC 120 GN**
Spare parts **HVC 120 GN**

Congratulations for the acquisition of this upmarket appliance made in France. You chose an appliance which alloys the best technical qualities with a big user-friendliness. We wish you the biggest contentment

| Rep | Code | Qty | Pièce | Spare part |
|-----|--------|-----|-----------------------|---------------------|
| 1 | 55084 | 1 | Toit | Roof |
| 2 | A10002 | 1 | Serre cable | Cord closer |
| 3 | C03013 | 1 | Cordon avec prise | Cord with plug |
| 4 | A03044 | 2 | Moteur ventilation | Ventilation motor |
| 5 | 55079 | 1 | Arrière | Back |
| 6 | 55085 | 1 | Renfort intérieur | Inside supplies |
| 7 | 55089 | 1 | Repose grille arrière | Rear grid holder |
| 8 | 55069 | 1 | Côté gauche | Left side |
| 9 | H04008 | 1 | Plat | Tray |
| 10 | A13006 | 4 | Pied | Foot |
| 11 | F08018 | 2 | Roulette sans frein | Wheel without brake |
| 12 | F08019 | 2 | Roulette avec frein | Wheel with brake |
| 13 | A06057 | 1 | Thermostat | Thermostat |
| 14 | A14078 | 1 | Bouton | Knob |
| 15 | A08003 | 1 | Voyant orange | Orange pilot light |
| 16 | A07033 | 1 | Interrupteur poussoir | Pushing switch |
| 17 | D02009 | 2 | Résistance blindée | Heating element |
| 18 | B09003 | 2 | Loqueteau | Small latch |
| 19 | 55076 | 6 | Support grille | Grid holder |
| 20 | 55068 | 1 | Côté droit | Right side |
| 21 | A15016 | 2 | Poignée | Handle |
| 22 | F01065 | 3 | Grille | Grid |
| 23 | 55083 | 1 | Socle | Base |
| 24 | 55081 | 1 | Fond socle | Bottom enclosure |

1. SECURITY INSTRUCTIONS

Please respect these instructions scrupulously to avoid any risk of fire, electric shock, scald or other wounds and damage. During the use of this appliance, fundamental circumspection of security must always be noticed, such as:

- Take into account the instructions to be systematically kept with the appliance.
- Install the appliance always in instructions respect. A 10 cm distance minimum with the partition or the wall is necessary.
- Protect the appliance from direct light of the sun, frost and humidity.
- Never leave the appliance within the reach of children or disabled persons without surveillance.
- Never move the appliance when it is working.
- Check that the appliance is definitely off before connecting it up or disconnecting it.
- Do not touch the hot surfaces of the appliance. The temperature of the hot surfaces can be very important when the appliance is working. Always use control knobs and handles.
- Do not use the appliance for other functions than determined use.
- Do not leave the cord of electrical feeding in the contact of hot surfaces.
- The appliance should not be used close to combustible materials.
- During use, look after not to obstruct hearings of aeration of the appliance
- To avoid any electric shock, never plunge the appliance, the cord or plug in water or quite other liquid.
- If the cord is harmed, it must be replaced by the producer, his after sale service or persons of similar skills to avoid any risk.
- Entrust compensations only to a skilled person.
- Use only spare parts of origin.
- Before cleaning the appliance, do not forget to disconnect it.

2. CONTENTS OF CARDBOARD PACKAGING

Device: A hot cupboard

Accessories:- Three grids

- An enamel plate
- Four adjustable feet
- Six grid holders
- Two wheels with brake
- Two wheels without brake
- The present note

Option : Container GN

See exploded views for HVC 60 GN / HVC 120 GN at the end of the document

3. CONFORMITY OF USE

Use the device only to reheat quickly or to keep warm empty or garnished plates and GN 2/3.

4. WAY OF FUNCTIONING

These ventilated hot cupboards are ideal to warm quickly and evenly and to keep warm empty plates or garnished food preparation in GN container. They are fitted with double insulated walls and roof, magnetic door closing, adjustable shelves and feet

You can add water in the enamel plate to maintain constant humidity degree inside the machine for fragile food.

HVC 60 GN = capacity of 60 plates Ø 34 cm or 3 GN 2/3 or 3 grids 330 x 345 mm.

HVC 120 GN = capacity of 120 plates Ø 34 cm or 6 GN 2/3 or 3 GN 1/1 on grids 695 x 345 mm.

To turn on your hot cupboard, just press the pushing knob (n°1 on picture), turn the thermostat control knob (n°3 on picture) on the desired temperature. The pilot light ignites (n°2 on picture) during heating and switches off once selected temperature is reached.

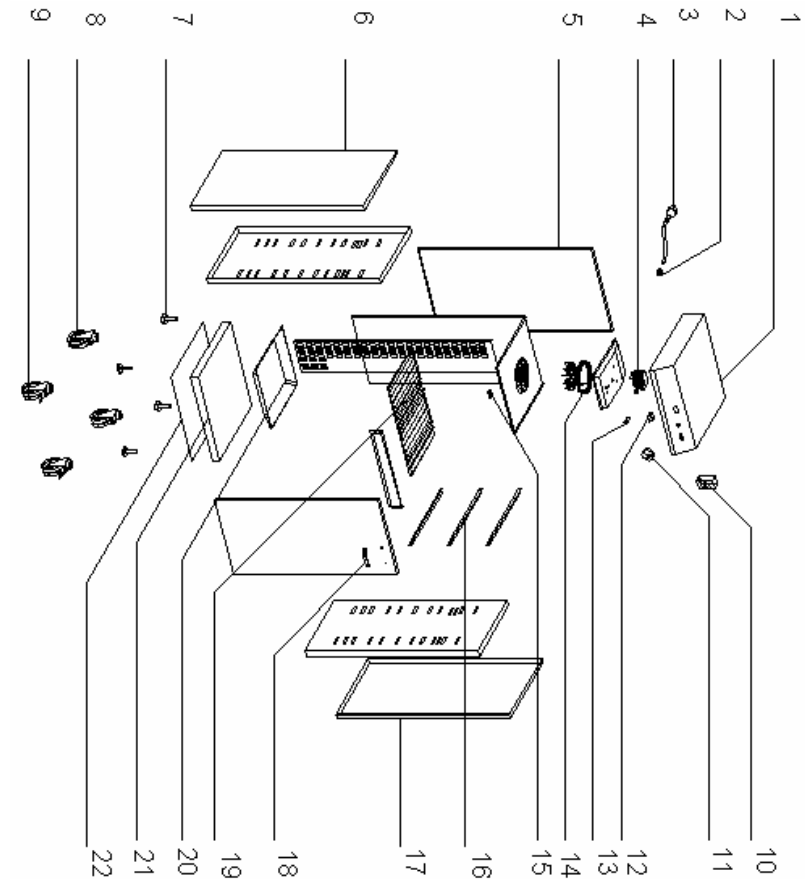

Nomenclature **HVC 60 GN**
Spare parts **HVC 60 GN**

| Rep | Code | Qty | Pièce | Spare part |
|-----|--------|-----|-----------------------|---------------------|
| 1 | 55077 | 1 | Toit | Roof |
| 2 | A10002 | 1 | Serre cable | Cord closer |
| 3 | C03002 | 1 | Cordon avec prise | Cord with plug |
| 4 | A03044 | 1 | Moteur ventilation | Ventilation motor |
| 5 | 55063 | 1 | Arrière | Back |
| 6 | 55069 | 1 | Côté gauche | Left side |
| 7 | A13006 | 4 | Pied | Foot |
| 8 | F08018 | 2 | Roulette sans frein | Wheel without brake |
| 9 | F08019 | 2 | Roulette avec frein | Wheel with brake |
| 10 | A06057 | 1 | Thermostat | Thermostat |
| 11 | A14078 | 1 | Bouton | Knob |
| 12 | A07033 | 1 | Interrupteur poussoir | Pushing switch |
| 13 | A08003 | 1 | Voyant orange | Orange pilot light |
| 14 | D02009 | 1 | Résistance blindée | Heating element |
| 15 | B09003 | 1 | Loqueteau | Small latch |
| 16 | 55076 | 6 | Support grille | Grid holder |
| 17 | 55068 | 1 | Côté droit | Right side |
| 18 | A15016 | 1 | Poignée | Handle |
| 19 | F01066 | 3 | Grille | Grid |
| 20 | H04008 | 1 | Plat | Tray |
| 21 | 55075 | 1 | Socle | Base |
| 22 | 55071 | 1 | Fond socle | Bottom enclosure |



1 Pushing knob

2 Pilot light

3 Thermostat

5. FUNCTIONING / MANIPULATION

a) Installation / assembly:

- Unpack carefully the device of its packaging.
- Place the machine on a plane and heatproof surface.
- Never place the device near a wall or near a partition makes of combustible materials even if it is very well isolated.
- A distance of minimum 10 cm with the partition or the wall is necessary.
- Remove the protective film around the machine and on the top
- Install the wheels or adjustable feet
- Place the grid holders and install the grids and the enamel plate

b) First starting:

First cleaning

Clean the device before the first use. (See 6 Cleaning)

Connection of the device

- Check that the tension and the frequency of the electricity network suit to the

- Check that neither the cord nor the plug are damaged
- Make sure that every control knob is positioned on 0.
- Unwind completely the electric power cable and connect it in a plug connected with the earth.
- The device is connected.

NB: in case of connection of the device in a plug without earth protection or directly on the electricity network, confide its connection to a qualified person .

c) Use of device :

Elements of command and display

| Command/Display | Function |
|-------------------------------------|--|
| Thermostat (n°3 on picture) | Temperature setting |
| Green pushing knob (n°1 on picture) | On/off |
| Orange pilot light (n°2 on picture) | Machine is heating (pilot light on) Temperature reached (pilot light off) |

Putting on

Press the pushing knob (n°1 on picture)
Turn on the thermostat control knob (n°3 on picture) on desired position : the orange pilot light (n°2 on picture) ignites. The machine is warming up.
Once orange pilot light (n°2 on picture) is off, the machine reaches the preset temperature.

Temperature setting

Set the temperature by positioning the thermostat (n°3 on picture) to the desired temperature.

Stopping the appliance

Set the thermostat control knob (n°3 on picture) on 0: the pilot light turns off, the appliance is no longer functioning.
Press the pushing knob
Let the device cool.
Disconnect the power cable.
Clean the appliance. (see 6. Cleaning)

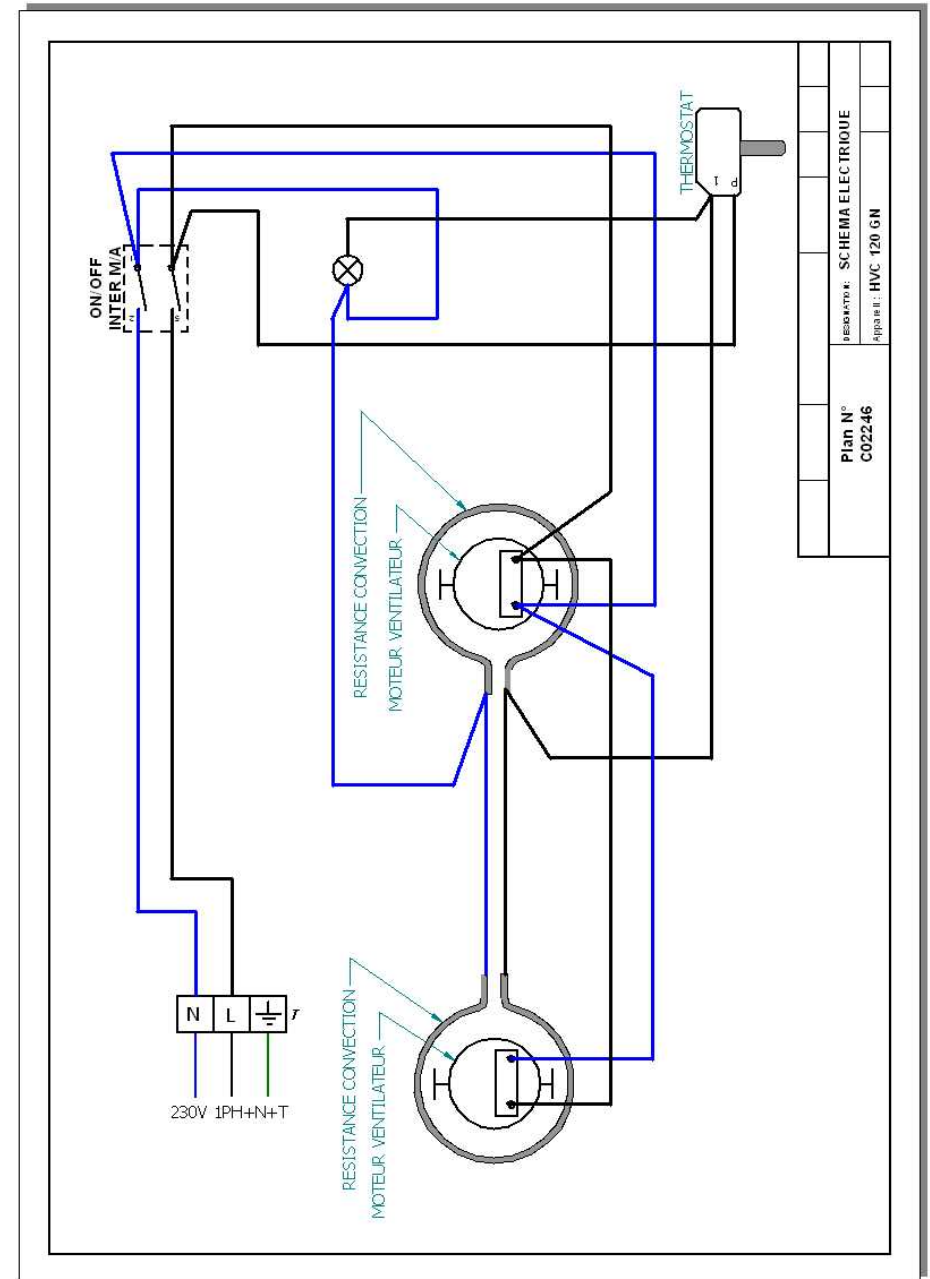

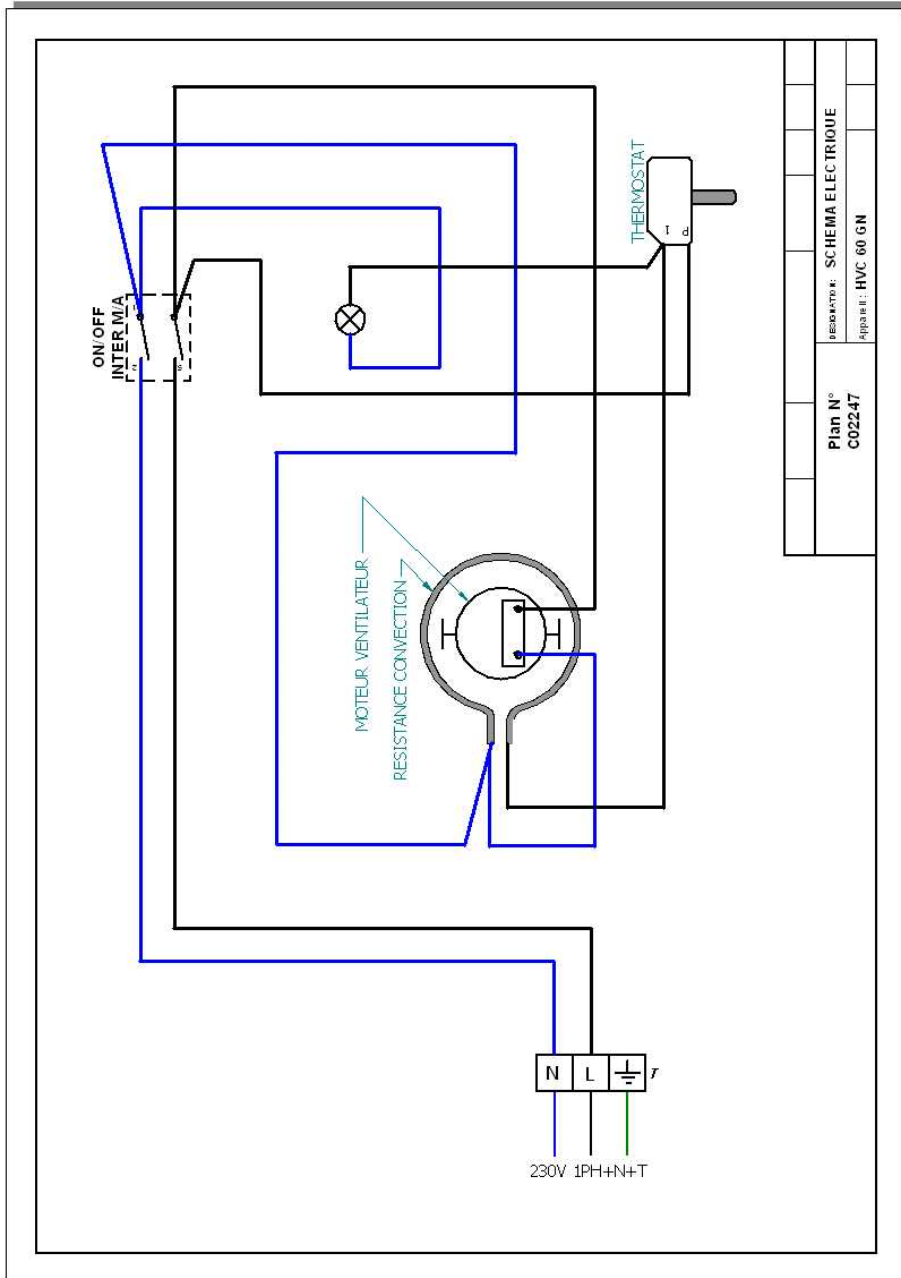

d) Breakdown / repair:

In case of breakdown or of damaged part, please call your after-sales service and confide any technical operation to qualified person.

When you contact the after-sales service of your distributor or your store, give him the complete reference of your device (commercial name, type and serial number). This information appears on the visible descriptive plate behind the device.

6. CLEANING AND MAINTENANCE

Disconnect the device.

- Let cool completely the device before any technical intervention or cleaning.
- For cleaning, only use non-abrasive products, clean regularly the external walls of your device with warm water and wash liquid: avoid the abrasive towelling. Rinse your device with a wet sponge.
- Never clean the device under a water jet, the infiltrations would risk to damage it in a irreparable way.
- Never immerse the device, the cord or the plug in the water or quite other liquid to avoid any electric shock.
- During a prolonged non-use, we recommend you strongly to keep the device shielded from the humidity.

7. CARACTERISTIQUES TECHNIQUES

| Models | HVC 60 GN | HVC 120 GN |
|--------------------|----------------|----------------|
| Outside dimensions | 425x460x925 mm | 800x460x925 mm |
| Weight | 30 Kg | 45 Kg |
| Power | 1500 W | 3000 W |
| No element | 1 | 2 |
| Current | 6.5 A | 13 A |
| Voltage | 220-240 V ~ | 220-240 V ~ |

Wires colours correspondence

| | |
|---------|----------------------|
| Phase | Brown / Black / Grey |
| Neutral | Blue |
| Earth | Yellow |

8. NORMS AND LEGALS DISPOSALS

The device is conform to :

IEC/EN 60335-1
IEC/EN 60335-2-49
EN 55014-1 +55014-2
EN 61000-3-2 + 61000-3-3

9. ELIMINATION OF THE ELECTRIC AND ELECTRONIC WASTE

The device respects the directives:

2002 / 96 / CE (DEEE) N°34270064800021
2002 / 95 / CE (ROHS)
2066/95 CE
2004/108 CE



Reach rule

Never put the device among household waste.

The device must be put down in a centre of recycling for the electric equipments.

The materials of the device are indeed reusable. By eliminating correctly the electric and electronic wastes, the recycling and quite other shape of re-use of worn equipments, you participate in a significant way in the environmental protection.

For any information about the collection of electric and electronic waste, please contact your distributor.

10. GUARANTEE

Conditions of guarantee

The guarantee applicable to any device is the commercial guarantee of the distributor or the retailer. Please contact the store where you bought your device to know the precise conditions.

The guarantee grants no right for damages.

The dispositions which follow are not exclusive of the profit of the legal guarantee planned by articles 1641 and following ones of the Civil code relative to the defects and the latent defects.

Exclusion clauses of the guarantee

Bad installation and bad maintenance, in particular if they do not respect current regulations or instructions appearing in this user guide.

Cannot benefit from the guarantee the repairs required as a result of false operations, of inappropriate use, of carelessness or of excess loads of the device, as well as those resulting from variations of the power supply, over tension or from defective installations.

The damage due to shocks, bad weather is not flatware by the guarantee. The material travels at the risks of the user; in case of delivery by carrier, the consignee has to have reservations towards the carrier before any delivery of the device.

The guarantee comes to an end in case of intervention, of repair, of modification by no qualified persons, or of use in inappropriate purposes.