

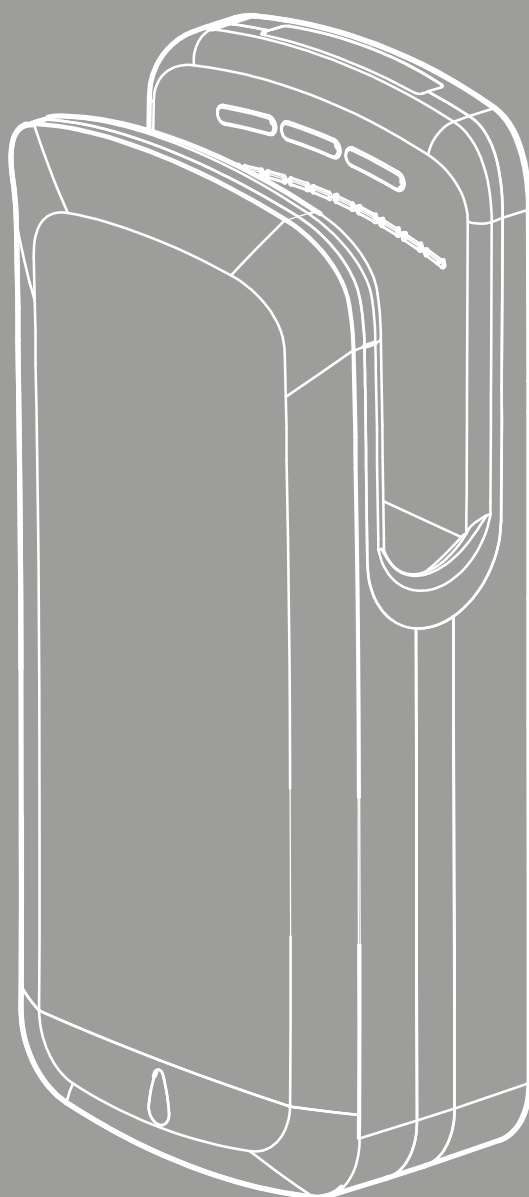

# JETBOX Blade

user manual



## 1. DESCRIPTION

The hand dryer is a surface-mounted hand dryer powered by a brush motor, and delivers 1650 watts of drying power. The dryer incorporates a replaceable HEPA filter and a reusable air intake prefilter. An infrared sensor is used to automatically activate the dryer. The dryer is intended for use in commercial, industrial, and office environments.

## 2. ADVANCE FEATURES

Slim, stylish design, improves washroom image.  
Powerful motor for rapid dry-time, and drip-tray for safe and hygienic washroom environment.  
25Seconds continuous timer protection.  
Anti-splash design.  
Cleaning required once per day.  
Air is cleaned by UV sterilisation and easily-changed HEPA airfilter.  
Substantial financial and eco savings by eliminating paper towel use.  
Adjustable heat and power settings allow optimum comfort and economy in all environments.

## 3. SPECIFICATIONS

Voltage:	220V-240V 50/60Hz <input type="checkbox"/> 110V-120V 60Hz <input type="checkbox"/>
Power/High Speed:	1650W-2050W(Heater on)/700W-800W(Heater off)
Power/Low Speed:	1450W-1850W(Heater on)/650W-700W(Heater off)
Air Temperature:	15°C above room temperature
Air Velocity:	100M/S
Air Flow:	130M <sup>3</sup> /H
Drying Time:	7-9S
Protection Level:	IPX1
Electric Isolation:	CLASS 1
Motor:	Brush Motor at 22000RPM
Noise(at 1M):	70dB
Cabinet Material:	ABS Plastic
Net Weight:	7.5 KGS
Gross Weight:	9.1 KGS

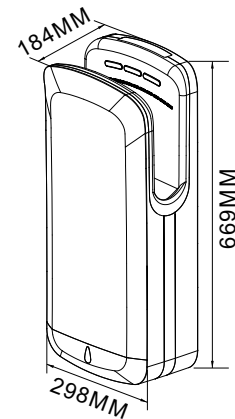

## 4. SAFETY INFORMATION

**⚠ DANGER** Failure to disconnect the power source before installation or servicing can result in serious injury or death from electric shock. Always disconnect the power source before servicing or installing the hand dryer.

**⚠ WARNING** Risk of fire, electric shock, personal injury or property damage are possible if local codes or safety recommendations are not followed.

- Do not use hand dryer for any purpose other than drying hands.
- Carefully follow all instructions for installation on the enclosed installation template/instructions.
- Installation should only be performed by qualified persons in compliance with all applicable national and local codes and standards.
- When cutting or drilling into wall or ceiling, do not damage electrical wiring and other hidden utilities.
- Always connect to a branch circuit with circuit breaker or fuse protection with an electrical rating greater than the hand dryer's rated amperage.
- Use only the electrical power(voltage and frequency) specified for the model hand dryer being installed.
- Each hand dryer must have a dedicated circuit.
- For indoor use only. Do not use outdoors. Do not expose to rain, sun or extreme temperatures. Do not use near source of water or extreme heat.
- To limit a voltage drop, and insure efficient operation, the correct size cable must be used.
- Repair work should only be performed by an authorized electrician.
- This appliance is not intended for use by persons with reduced physical, sensory or mental capabilities, or lack of experience and knowledge, unless they have been give supervision or instruction concerning use of the appliance by a person responsible for their safety.

**⚠ WARNING** Risk of fire, electric shock, personal injury or property damage are possible if the following safety precautions are not followed.

- Repair work should use only genuine replacement parts.
- Do not insert foreign objects in the unit or place heavy objects on the unit.
- Do not use in corrosive environments or explosive atmospheres.
- Do not use in extremely humid locations or near source of water.
- Do not immerse appliance in water or other liquid.
- Children should be supervised and must not play with the appliance.

**⚠ WARNING** When you dispose of an old appliance or any components, follow any local and national laws on disposal of electronic waste. This appliance must not be disposed together with the domestic waste. This appliance must be disposed at an authorized place for recycling of electrical and electronic appliances.

## 5. UNPACKING / STANDARD ACCESSORIES

1. Remove all packing material. Recycling is recommended.
2. Carefully remove the hand dryer from the shipping carton, using care not to drop the appliance.
3. Inspect carefully for any damage that may have occurred during transit. Check for any loose, missing or damaged parts. If the hand dryer is damaged or missing parts, promptly inform the dealer where you purchased it.

Standard items included with the hand dryer are:

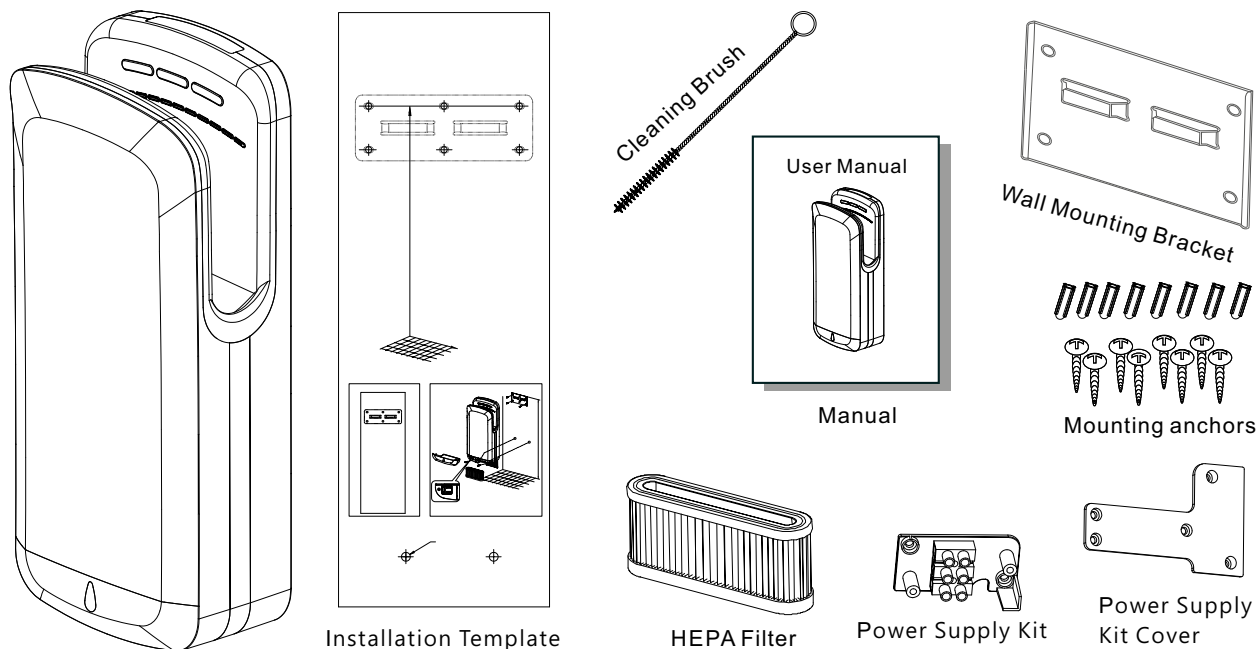

## 6. INSTALLATION

**CAUTION** Improper mounting may result in personal injury or property damage.

1. Use the mounting template provided to mark the locations for the 8 wall mounting anchors to attach the wall mounting bracket to the wall.
2. It is recommended that at least 2 of the 6 mounting anchors for the unit be fastened into a wall stud or support.
3. To use the hollow wall anchors included with the wall mounting kit, pre-drill the wall in the marked locations using a 6/25" (6mm) drill, insert the plastic anchors and tap flush to the wall.
4. Complete the attachment of the wall mounting bracket to the wall with the 6 mounting anchors.
5. If the hand dryer supplied with plug then hang it on bracket.
6. If the hand dryer is supplied without plug and please open the power supply kit cover on hand dryer back then connect it as follows <Power should be OFF>:
  - A. Connect the live wire (Coloured Brown, Red, or Black) to the terminal block marked "L".
  - B. Connect the neutral wire (Coloured Black, Blue) to the terminal block marked "N".
  - C. Connect the ground wire (Coloured Green & Yellow) to the terminal block marked "E".
 Replace power supply kit cover then hang dryer on bracket.
7. Remove the water collection tray from the bottom of dryer, and complete the attachment of the dryer with the remaining 2 anchors.
8. Set the Heater/Air Speed setting switches as required.
9. Replace the water collection tray.
10. Open the pre-filter to install the HEPA filter if necessary with rubber ring side up.
11. Connect plug to power supply socket or turn on power.

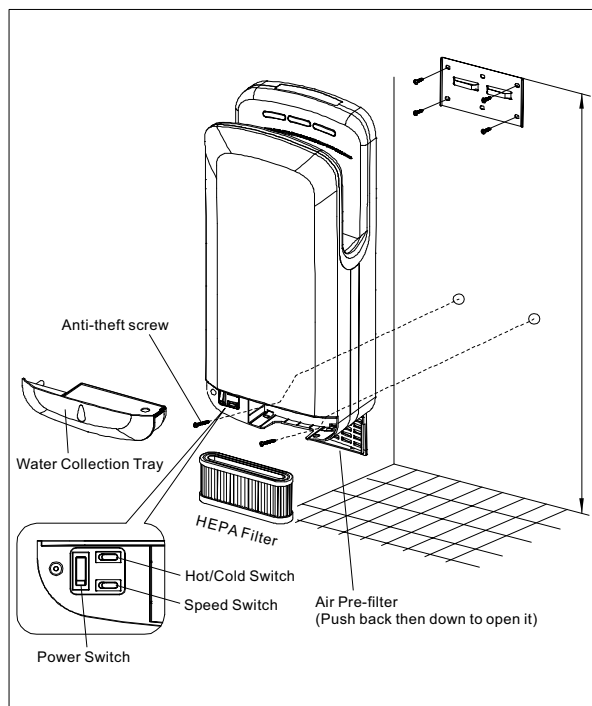

## 7. HOW TO USE

1. Automatic, no-touch operation.
2. There is a blue LED light to guide user to the air flow.
3. The hand dryer will start automatically when hands are inserted.
4. Slowly move your hands up and down through the air stream for 7-10 seconds.
5. The hand dryer will stop automatically after hands are removed.

The LED display provides information about the operation and servicing needs of the hand dryer.

- A. Drying time and welcome diagram  
C. Air sterilization indicator

- B. Power indicator  
D. Self-check indicator

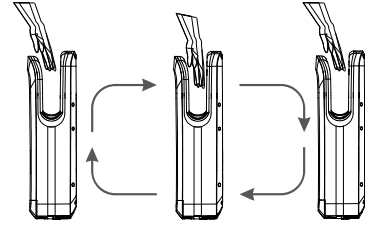

The dryer is equipped with an ON/OFF Power Switch, Speed Control Switch and Hot/Cold Switch.

The factory default setting for the Power Switch "ON", Speed Control Switch "HIGH" and Hot/Cold Switch "HOT". All the switches are located inside the dryer on the left side of the water collection tray. To access, remove the water collection tray.

## 8. Maintenance and Cleaning Instructions

**CAUTION on HEPA:** Failure to replace a used / dirty HEPA filter can cause overheating of the hand dryer's motor or heat element and may invalidate your warranty. It is recommended to check it once per week.

1. This hand dryer is equipped with removable intake air pre-filter and a replaceable HEPA filter.
2. Regularly check filter status is required. High traffic may require more frequent replacement of the HEPA filter.
3. The removable intake air pre-filter can be cleaned and re-used.
4. Replacement filters can be purchased through your dealer where you purchased the hand dryer.
5. HEPA filter is recommended to be cleaned by a vacuum cleaner.

**CAUTION on Water Collection Tray:** Check the water level regularly via the front viewer and empty as required. Clean the tray and replace it. If the tray is overfull, it will overflow onto the floor and may present a slip hazard.

### CLEANING

All surfaces of the hand dryer can be cleaned with a soft cloth and non-abrasive, non-caustic cleaning solutions. A cleaning brush for the drain hole in the bottom of the drying cavity is provided.

## 9. DIAGNOSTICS & REMEDIES

SYMPTOM	CORRECTIVE ACTION
Hand dryer fails to start	Check power supply is turned on and the power switch on the hand dryer is on. Check for foreign objects in the drying cavity that maybe blocking the sensors. Insert hands a little further into the drying cavity to activate sensors.
Hand dryer turns on/off erratically	Clean sensor area inside the drying cavity.
Not hot air	Heater will not work if ambient temperature is more than 25 C Check heater switch is on and fuse is intact.
Low air speed	Switch speed control to "H". Check and clean filters.
Hand dryer locked	Hand dryer will be locked if the supply voltage fluctuates by more than 15%. Turn off the hand dryer for 10 minutes and then restart.

## 10. LIMITED WARRANTY

This hand dryer has a 2 year warranty from the date of purchase for any manufacturing defect. It covers replacement of defective parts except when caused by improper use of the hand dryer. It excludes motor brush replacement.

This warranty is only valid if the form card has been properly completed.

For any warranty claim you should contact your supplier.

Model:..... Serial No.:.....

Distributor:..... Customer:.....

Address:.....

Tel No.:..... Fax No.:.....

Date of purchase:.....

For Seller:..... Signature : .....



## Replace HEPA Filter and Clean Pre-filter

**⚠ WARNING:** Disconnect power at the service breaker or unplug the hand dryer before servicing & maintenance.

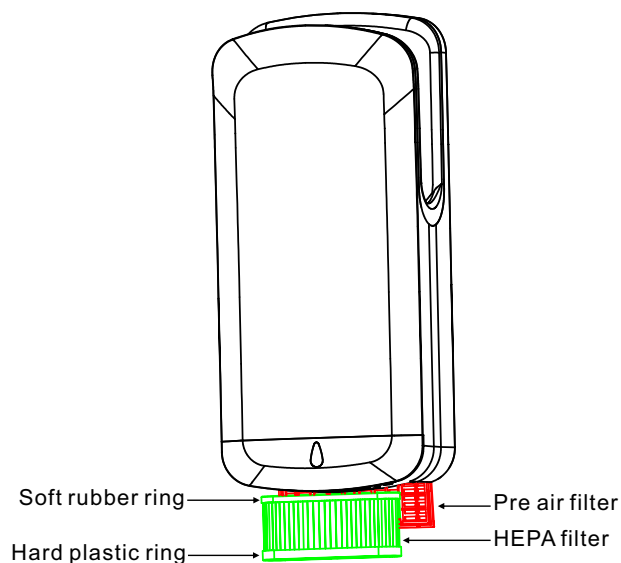

1. Press back then down to remove the pre-filter.
2. Take the HEPA filter out. When replacing the HEPA filter, ensure the soft rubber edge is uppermost.
3. Clean any dust from the pre-filter.

## Replace water tray and uninstall hand dryer from wall

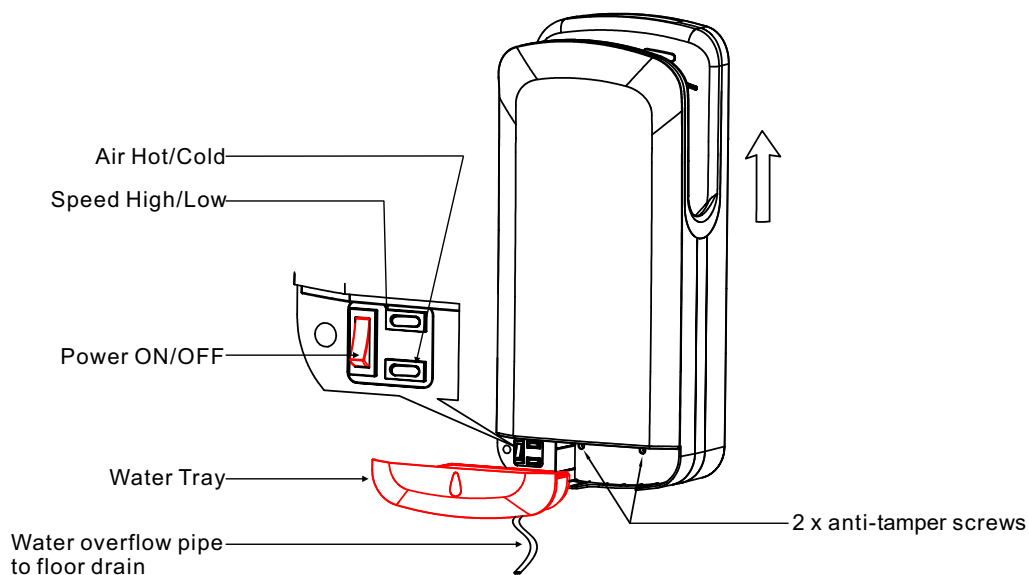

1. If there is a water overflow pipe connected, remove it.
2. Remove the tray by pulling it forward. Then undo the 2 x anti-tamper screws.
3. First pull up then pull front to take hand dryer from wall. Do this carefully as the dryer weighs 11KG.
5. On reinstallation, before replacing the water tray, make sure the heater and speed switches are set as required.

## Replace Sensor Detector & LED Light Circuit Board

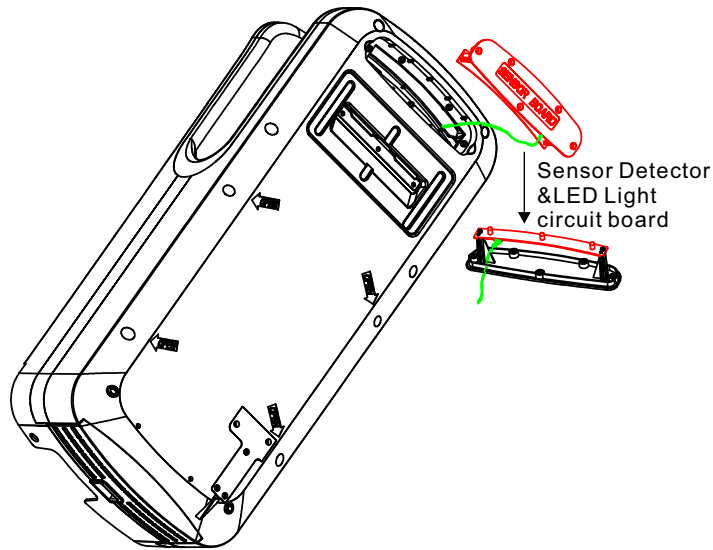

### **Replace Sensor Detector&LED Light Circuit Board:**

1. Loosen screw on the sensor detector&LED light circuit board holder. Use a screwdriver to pull the cover a little to open it.
2. Take carefully remove the cover along with the circuit board. Take care of the wire connected to the circuit board.
3. Loosen the 2 screws on the circuit board and replace with the new one.

## Replace Display Circuit Board

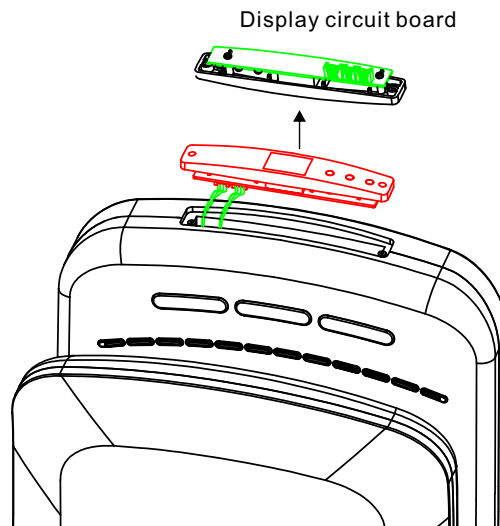

### **Replace Display Circuit Board:**

1. Remove the sticker. Take care not damage the hand dryer edge.
2. Loosen the two screws on the timer circuit board holder. Use a screwdriver to pull the holder a little to open it.
3. Gently remove the holder and the circuit board will come out. Take care of the adjoining wire.
4. Loosen the two screws on the circuit board and replace with the new one.
5. It is recommended to also replace the sticker.

## Open hand dryer front cover

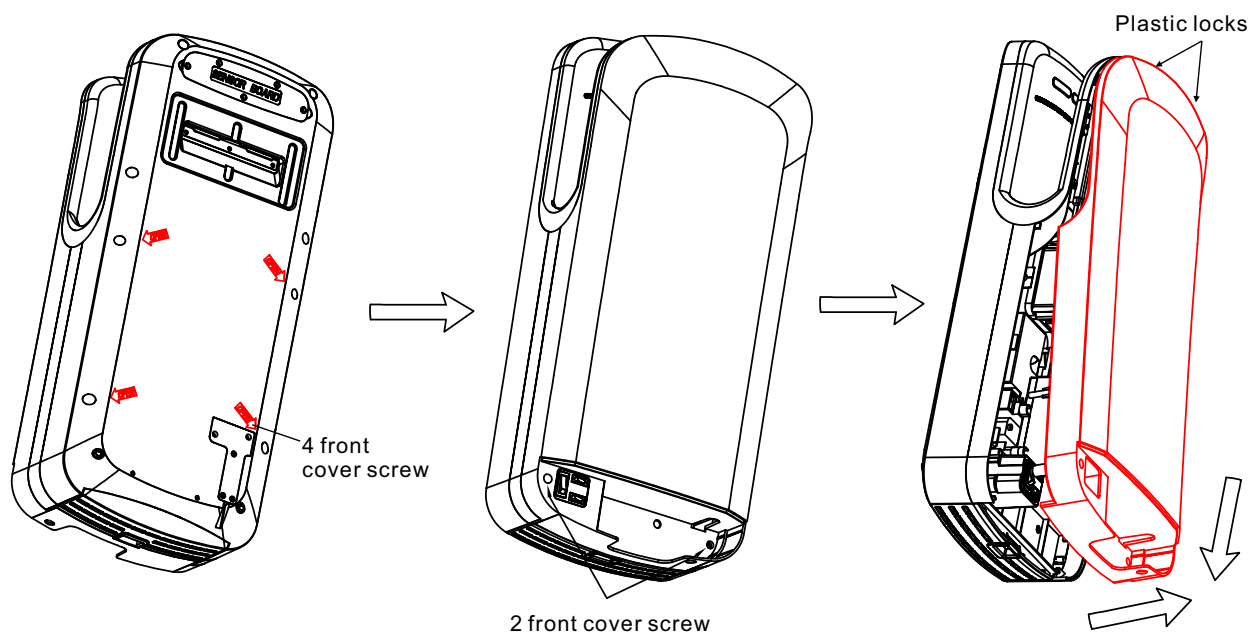

1. Loosen the 4 front cover screws on hand dryer back base as per the arrows marked.
2. Loosen the 2 front cover screws on the hand dryer front & underside.
3. Pull the front cover up then back a little to remove it.
4. Pull the cover slowly and gently taking care of the plastic locks on the top side.

## Replace Main Circuit Board, Sensor Receiver Board, Motor, Heat Element

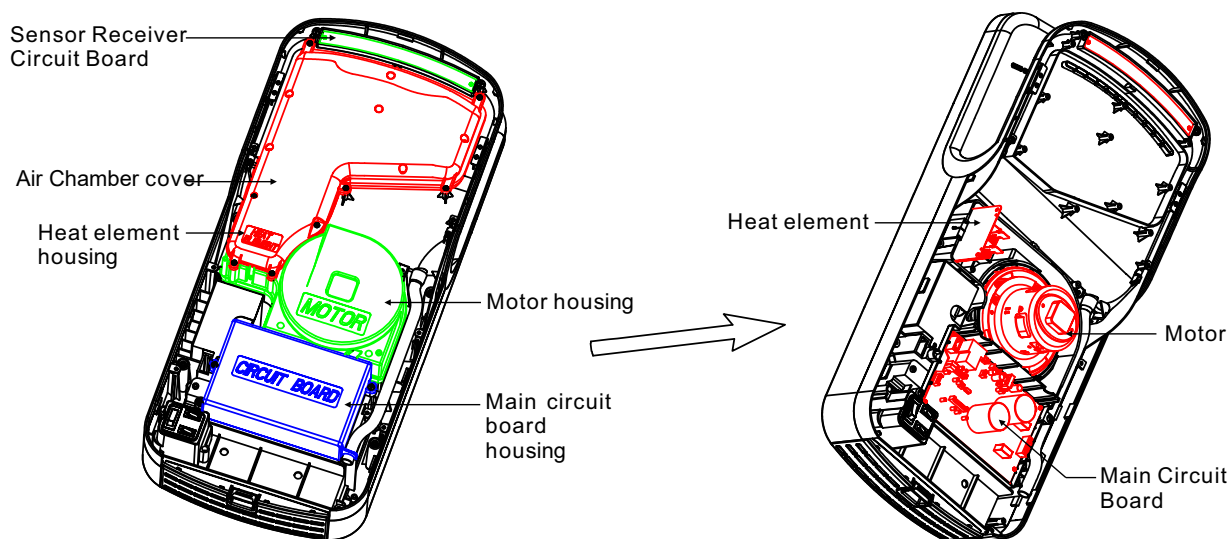

**Replace Main Circuit Board:** Remove circuit board cover and replace the circuit board.

**Replace Sensor Receiver circuit board:** Undo the screw, remove the circuit board and replace.

### **Replace Heat Element:**

1. Move marked Air Chamber cover. Remove the heat element and fit the replacement.
2. Replace Air Chamber cover. Ensure the air seal rubber is seated correctly to avoid air leakage.

### **Replace Motor:**

1. Remove the Air Chamber cover and Motor housing. Remove the motor and replace it.
2. Replace motor housing. Ensure the motor protection rubber and air seal rubber fits correctly.
3. Replace Air Chamber cover. Ensure the air seal rubber is seated correctly to avoid air leakage.

## Hand Dryer by Brushless Motor Electric Diagram

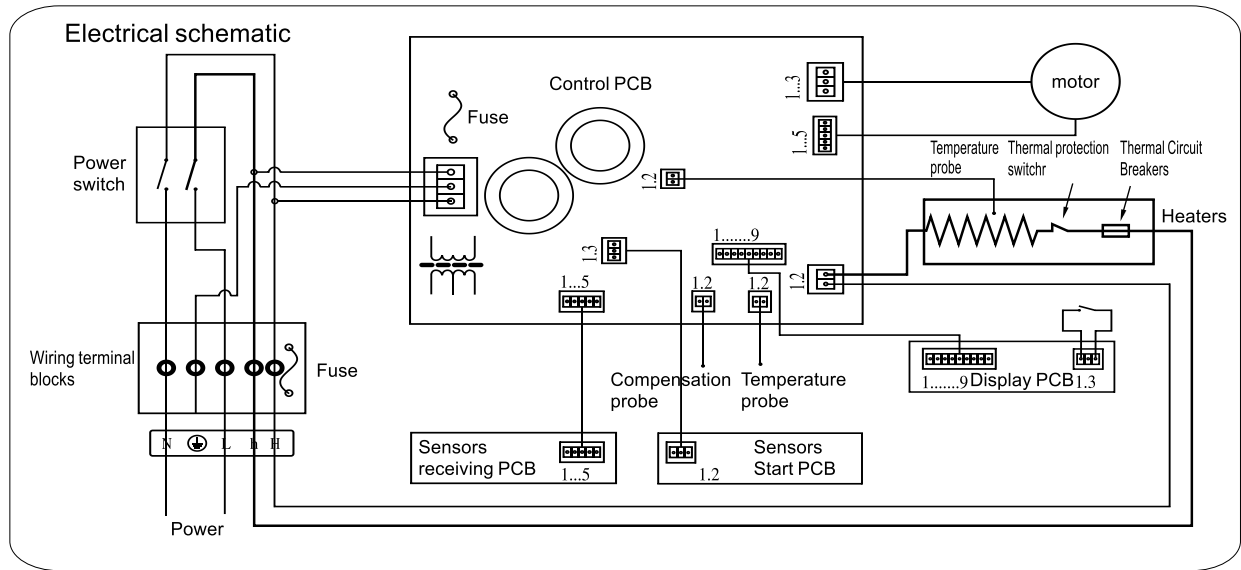

## Hand Dryer by Brush Motor Electric Diagram

