

DAILY USE & MAINTENANCE

1 External Maintenance

Clean with a soft cloth. If the unit is very dirty use a soft, dampened cloth with a neutral cleaning agent, then polish with a soft, dry cloth

- Only use neutral cleaning agents
- Do not use thinners, acidic or alkaline toilet cleaners or nylon brushes (they may damage the surface)
- If using chemical cloths, read instructions first
- Disinfecting agents will damage the unit

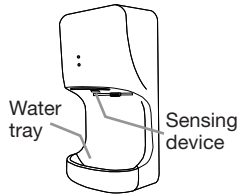

2 Empty excess water

To prevent water from overflowing it is necessary to regularly empty the excess water tray

- If the accumulated water is left in the drain tank it may degrade and start to smell!
- Regularly wash and disinfect the inside of the drain tank

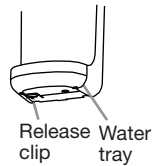

3 To clean the filter

Remove the filter unit

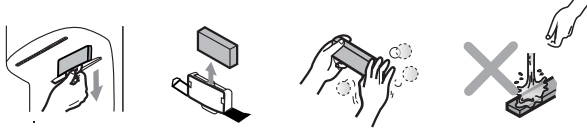

This should come out easily by holding the raised piece and pulling gently downwards

Remove the filter from the unit

Clean the filter by tapping or using a vacuum cleaner

DO NOT use water to clean the filter

Replace the filter every 3 years

4 Switch power on

Use as normal



Place hands inside the unit, palms down. Move backwards and forwards in the air flow

Turn hands and repeat backwards and forwards motion

Finally rub hands together to remove any final dampness

COMPONENTS

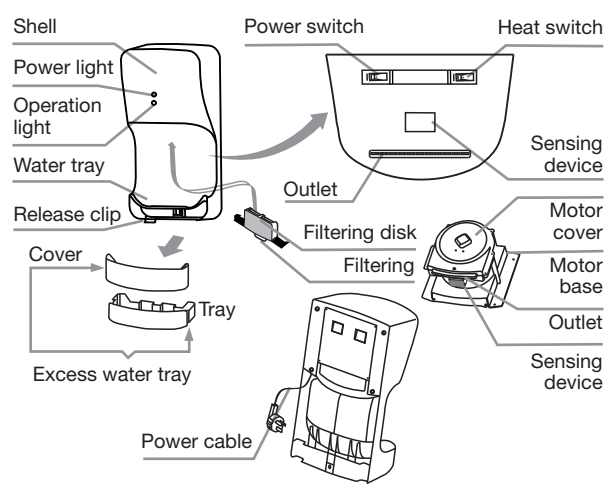

ELECTRICAL SCHEMATIC

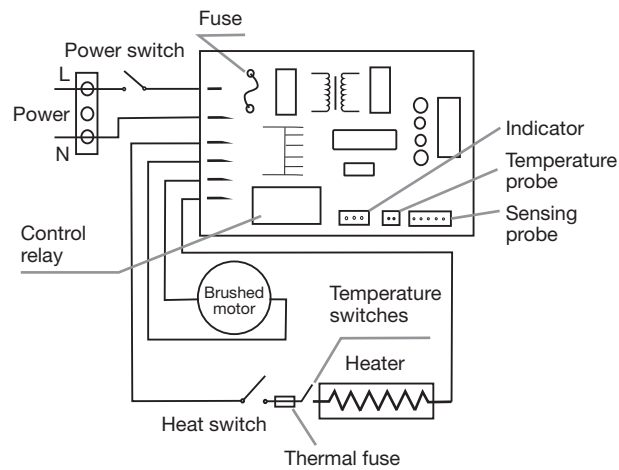

PACKING LIST

Crocodillo T2	1
30mm self tapping screws	5
5mm expansion pipe	1
User manual	1



User Manual

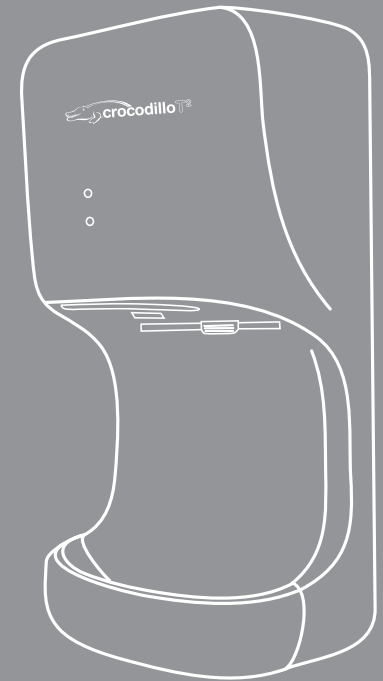

handydryers



WARNING: INJURY MAY OCCUR IF MISUSED



Prohibited

- Do not open the front panel – electric shock risk
- Do not allow children or adults to pull or hang on the machine
- Place the unit away from direct water supplies
- A suitably rated fused power supply is required



Do not allow unit to get excessively wet

- Ensure the correct power supply is used, if more than +/-10% the unit may malfunction
- The power must be turned off during maintenance
- The drain tank and air filter must be installed for correct operation



Do not dismantle

- Ensure the unit has a reliable earth connection
- Do not install connected to a power supply
- This hand dryer must be installed by a qualified electrician



Follow instructions carefully

- If the power cord is damaged it must be replaced by the manufacturer, its service agent or a qualified person
- A residual current device (RCD) with a rated residual operating current, not exceeding 30mA is recommended
- If power tolerance is above +/- 10% the machine will malfunction
- Please use dedicated spur
- Switch off the power during maintenance
- Excess water tray and filter must be installed
- In case of malfunction, switch off power immediately
- Ensure power is not connected during installation



Environmental Protection

- Do not dispose of electrical waste with household waste, please recycle in appropriate facilities. Check with your Local Authority or retailer for recycling advice.

SPECIFICATION TABLE

Voltage	AC220-2400V~	Motor	Brush motor
Phase	Single-phase	Sensing distance	9–15cm
Input	1400-1650W	Protection class	IPX4
Air drying speed	105m/s	Unit dimensions	250 x 175 x 488mm
Heating power	800-950W	Net weight	4.3kg

PRE-INSTALLATION PRECAUTIONS & INSTALLATION LOCATION

DO NOT install in the following places

- Where the temperature can be below -10°C or above 40°C
- Where the unit may come into direct contact with excessive water
- If the unit will be in direct or strong sunlight
- If there is a lot of condensation in the environment
- If there are corrosive, neutral or reductive gases present
- 20m or more below, or 2000m or higher than, sea level

Installation position

- The following picture shows the recommended position
- Ensure there is at least 150mm clear space below the machine (either to the floor or other objects in the location)
- It is recommended that a minimum distance of 100mm should be left clear to either side of the unit
- Avoid locations where people or doors might damage the unit
- Choose a completely flat wall surface to mount the unit to

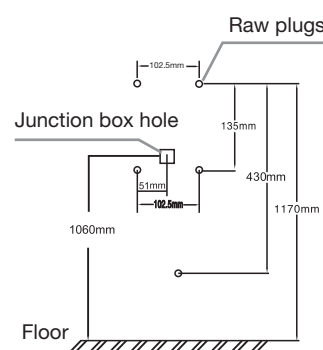

INSTALLATION

1 Install metal wall plate

- Fix the metal wall plate to the wall with 5 screws and raw plugs

- A long power cord is supplied with this machine, trim excess and connect to junction box or spur.

Live = brown wire, neutral line = blue

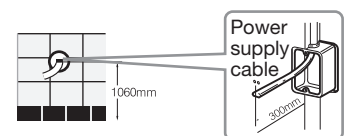
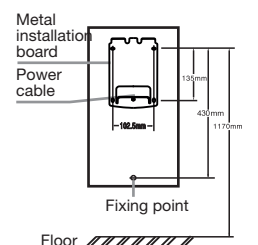

2 Remove water tray

- Using one hand hold the clip open whilst pulling the tray out with other hand

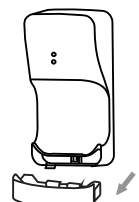

3 Hang the unit

- Hang the unit on the metal wall plate
- Attach the unit to the wall including 5th fixing screw behind water tray

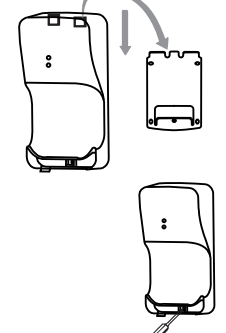

4 Fix metal wall plate screw

- Remove the filter
- Using the single screw, at an angle of 45°, fix the unit through the filter hole, tighten gently until the unit is fixed firmly to the wall plate

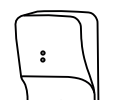
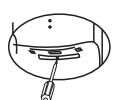

5 Replace all components

- Replace filter and excess water tray – See diagram

