

Lynx 400 Pasta Boiler

Key Features

- Type: Electric
- Counter top unit
- Removable control panel and element
- Thermostatic temperature control (six position)
- Incoloy element
- Boil dry protection
- Supplied with perforated basket and batter plate



LPB

Construction

- Body: stainless steel grade 430
- Tank: stainless steel grade 304
- Basket: stainless steel grade 304

Available Options

- N/A

Available Accessories

- BA158 - Half size basket insert (pair)

Specifications

Model	LPB
External height (mm)	315
External width (mm)	270
External depth (mm)	417
No. of baskets	1
Basket dimensions h x w x d (mm)	75 x 198 x 198
Tank capacity (litres)	5
Net weight unpacked (kg)	11
Gross weight packed (kg)	12
Shipping volume (m ³)	0.090
Total power rating (kW)	3
Electrical supply 1N~+E 230V 50-60Hz Current Rating (A)	13

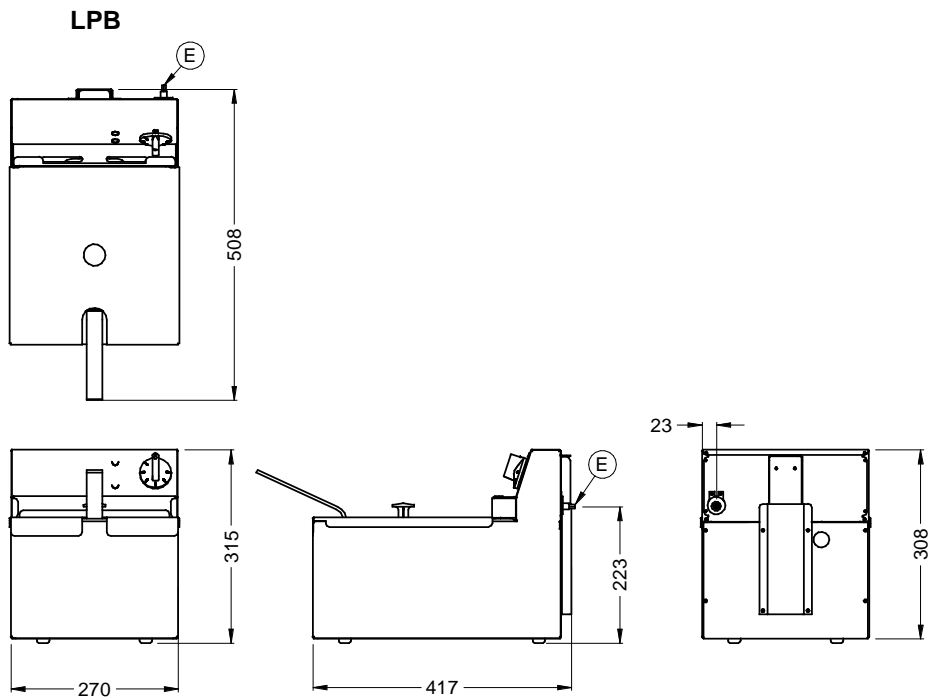

Lincat Limited, Whisby Road,
Lincoln LN6 3QZ,
United Kingdom

UK Sales Tel: 01522 875500 UK Spares Tel: 01522 875510 UK General Tel: 01522 875555
 UK Fax: 01522 875530 International Sales Tel: +44 1522 503250 International Fax: +44 1522 875530
 Website: www.lincat.co.uk UK Sales e-mail: sales@lincat.co.uk International Sales e-mail: export@lincat.co.uk



Document ref:
LYNXLPB
Issue date: Feb-17