

Zen Ice

Cold Drinking Water Taps Solo, Spa or Life



Usage

The elegant Zen Ice tap range can be used to supply varying combinations of cold (ambient), chilled and sparkling water. Ideal for use with the Zen Font with Drain in many domestic and commercial applications including office kitchens and canteens.

p.28

Features and Benefits

- Stylish and practical Zen range tap
- Suitable for filling sports bottles and carafes
- Instant high quality filtered drinking water. Filter and installation kit supplied with all models (F1T) (see page 36).
- 360° swivel tap
- Polished chrome finish as standard. Other finishes available on request.
- Zen Ice Solo single outlet tap provides any one of cold (ambient), chilled and sparkling options
- Connect your Zen Ice Solo tap directly to the mains cold water supply for a low cost filtered cold (ambient) only drinking water option
- Team your chosen tap with one of our Sapphire Undersink Chillers if you want to provide chilled and/ or sparkling water (page 24 to 27)
- Zen Ice Spa double outlet tap provides any two of cold (ambient), chilled or sparkling water options
- Zen Ice Life combines hot and cold kitchen mixer with any one of cold (ambient), chilled or sparkling water options

Product Code	Tap Type	360° Swivel	
ICOSOLO	Single outlet	Yes	
ICESPA	Double outlet	Yes	
ICELIFE	Kitchen mixer plus single outlet	Yes	Coming Soon

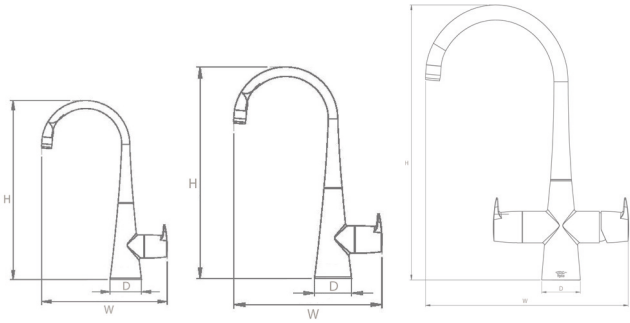

Outer Casing

Polished chrome finish
Other tap finishes available on request at additional cost

Installation

Required hole diameter for mounting the tap 32mm.
Fits in a standard sink.
Sink/ counter top up to 50mm thick.

Plumbing

Must be installed by a suitably qualified person.

Supplied with all fittings required including adaptors to facilitate connection to 15mm copper pipe.

Standard Warranty

2 year parts or replacement warranty.

Product Code	Height (mm)	Width (mm)	Depth (mm)	Weight (kg)
ICESOLO	288	152	49	1.1
ICESPA	320	224	56	1.6
ICELIFE	365	286	54	2.5